

MH-EMT STRUT CLAMP — 45EMT

Product Features

- Pre-assembled out of box; tightening screw at 45° angle for easy access
- Sized for electrical metallic tubing (EMT)
- Pre-galvanized
- Innovative design requires no nuts for fast and easy assembly

Material Specifications

Material	Carbon steel
Finish	Pre-galvanized
Conforms with	<ul style="list-style-type: none"> • Federal specifications WW-H-171E (Type 59) • Manufacturers Standardization Society MSS-SP-58 (Type 59)



Ordering Information / Technical Data

Description	Allowable Load 1 (lb) ¹	Box Qty	Item No.
MH-EMT45 1/2" PG	133	100	2008821
MH-EMT45 3/4" PG	167	100	2008822
MH-EMT45 1" PG	200	100	2008823
MH-EMT45 1-1/4" PG	200	50	2008824
MH-EMT45 1-1/2" PG	200	50	2008825
MH-EMT45 2" PG	200	50	2008826

¹ Load rating is defined per CSA C22.2 No.18.4-15 criteria

Technical Data

Designation	Bolt Diameter x Length	Wrench Size	Tightening Torque (in-lb)	Material Thickness Gauge	A Dimension (in)	B Dimension (in)	C Dimension (in)
MH-EMT45 1/2" PG	5/16"-18 UNC x 3/4"	1/2"	60	16	1.98	0.65	0.82
MH-EMT45 3/4" PG	5/16"-18 UNC x 3/4"	1/2"	60	16	2.20	0.75	1.04
MH-EMT45 1" PG	5/16"-18 UNC x 3/4"	1/2"	60	14	2.47	0.87	1.31
MH-EMT45 1-1/4" PG	5/16"-18 UNC x 1"	1/2"	60	14	2.81	1.05	1.66
MH-EMT45 1-1/2" PG	5/16"-18 UNC x 1"	1/2"	60	14	3.05	1.17	1.89
MH-EMT45 2" PG	5/16"-18 UNC x 1"	1/2"	60	14	3.50	1.39	2.35

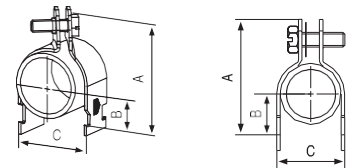
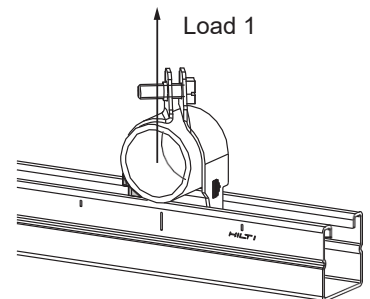

Installation Instructions

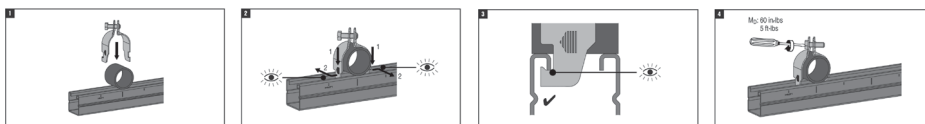

COLLIER DE SERRAGE MH-EMT — 45EMT

Caractéristiques du produit

- Pré-assemblé hors de la boîte; vis de serrage à 45° pour un accès facile
- Dimensionné pour les tubes électriques métalliques (EMT)
- Pré-galvanisé
- La conception innovante ne nécessite aucun écrou pour un montage rapide et facile

Spécifications des matériaux

Matériau	Acier au carbone
Finition	Pré-galvanisé
Satisfait à	<ul style="list-style-type: none"> • Spécifications fédérales WW-H-171E (Type 59) • ManufacturersStandardizationSociety MSS-SP-58 (Type 59)



Informations de commande / Données techniques

Description	Charge admissible 1 (lb):	Qté par boîte	No. d'article
MH-EMT45 1/2" PG	133	100	2008821
MH-EMT45 3/4" PG	167	100	2008822
MH-EMT45 1" PG	200	100	2008823
MH-EMT45 1-1/4" PG	200	50	2008824
MH-EMT45 1-1/2" PG	200	50	2008825
MH-EMT45 2" PG	200	50	2008826

1 Le taux de charge est défini par les critères de la norme CSA C22.2 No.18.4-15

Données techniques

Désignation	Diamètre du boulon x longueur	Taille de clé	Couple de serrage (po-lb)	Mesure de l'épaisseur de matériau	A Dimension (po)	B Dimension (po)	C Dimension (po)
MH-EMT45 1/2" PG	5/16"-18 UNC x 3/4"	1/2"	60	16	1,98	0,65	0,82
MH-EMT45 3/4" PG	5/16"-18 UNC x 3/4"	1/2"	60	16	2,20	0,75	1,04
MH-EMT45 1" PG	5/16"-18 UNC x 3/4"	1/2"	60	14	2,47	0,87	1,31
MH-EMT45 1-1/4" PG	5/16"-18 UNC x 1"	1/2"	60	14	2,81	1,05	1,66
MH-EMT45 1-1/2" PG	5/16"-18 UNC x 1"	1/2"	60	14	3.05	1.17	1.89

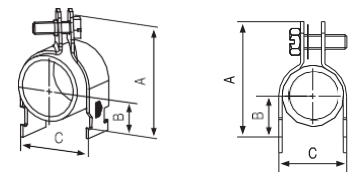
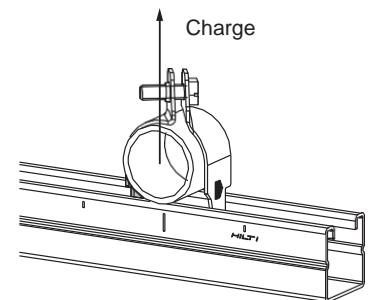

Instructions d'installation

