



Classified by
Underwriters Laboratories, Inc.
to UL 2079 and CAN/ULC-S115

System No. FF-D-0161

FFD 0161

ANSI/UL2079	CAN/ULC S115
Assembly Ratings — 2 Hr	F Ratings — 2 Hr
Nominal Joint Width — Min. 1/2 to Max. 1-1/8 In. (See Item 2)	FT Ratings — 2 Hr
Class II Movement Capabilities — See Table 1	FH Ratings — 2 Hr
	FTH Ratings — 2 Hr
	Nominal Joint Width — Min. 13 to Max. 29 mm (See Item 2)
	Class II Movement Capabilities — See Table 1

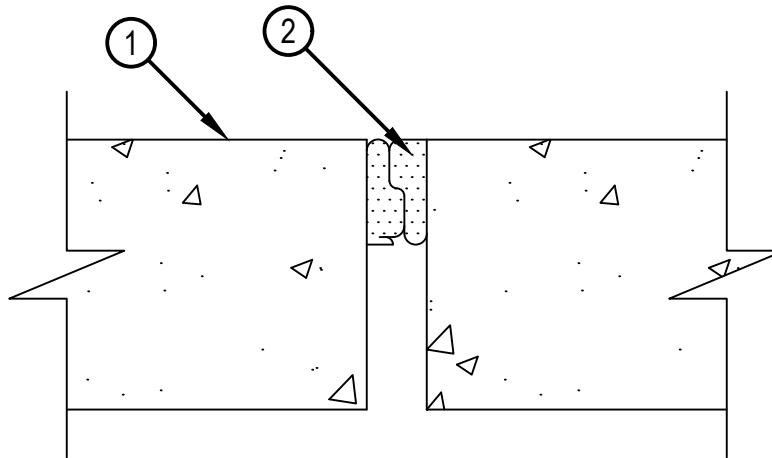

1. Floor Assembly — Min 4-1/2 in. (114 mm) thick reinforced lightweight or normal weight (100-150 pcf or 1600-2400 kg/m³) structural concrete.
 2. Joint System — Max width of joint (at time of installation of joint system) is 1 in. (25 mm) or 1-1/8 in. (29 mm). The joint system is designed to accommodate max compression and extension as described in Table 1. The joint system shall consist of the following:
 - A. Fill, Void or Cavity Material* — CFS-TTS MD Top Track Seals installed as factory supplied foam seal within the joint. Both sides of Hilti CFS-TTS MD are inserted into the joint by rolling the product onto itself with the opposing contour ends nesting together. The top surface of the product shall be flush with top of the concrete floor. For floors thicker than 4-1/2 in (114 mm), the product may be recessed from the top surface of the floor at a max distance of 1-1/4 in. (38 mm). Note: IF CFS-TTS MD OS is used, it must be installed with both sides of the foam barrier as supplied from the manufacturer.
- HILTI CONSTRUCTION CHEMICALS, DIV OF HILTI INC — CFS-TTS MD OS or CFS-TTS MD 600 Firestop Top Track Seal

Table 1

Joint Width, in (mm)	Compression, %	Extension, %
1 (25)	50	12.5
1-1/8 (29)	44	0

* Indicates such products shall bear the UL or cUL Certification Mark for jurisdictions employing the UL or cUL Certification (such as Canada), respectively.



Reproduced by HILTI, Inc. Courtesy of
Underwriters Laboratories, Inc.
December, 30 2022